

# CLICK HOLDER HQ-CLC



## Installation manual

Web: [www.hqmount.com](http://www.hqmount.com)

Email: [info@hqmount.com](mailto:info@hqmount.com)

### Components

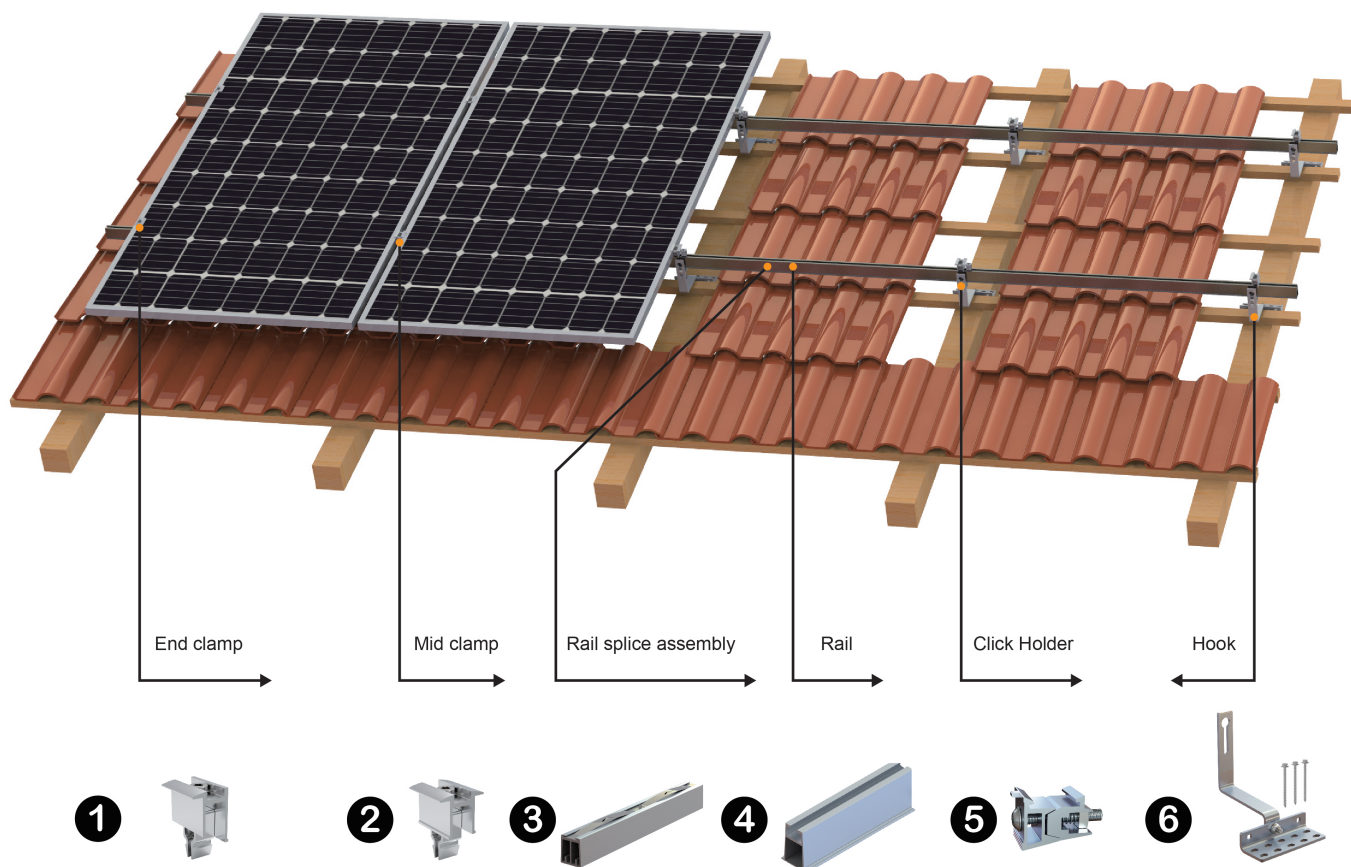

### Installation Tools

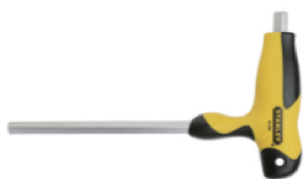

M8 Allen key



Marker



Tape measurement



Electrical drill

# CLICK HOLDER HQ-CLC



## Installation manual

Web: [www.hqmount.com](http://www.hqmount.com)

Email: [info@hqmount.com](mailto:info@hqmount.com)

### Step 1 Installation-Hook

Mark A/B location for hook  
(Make sure it's on the same line)

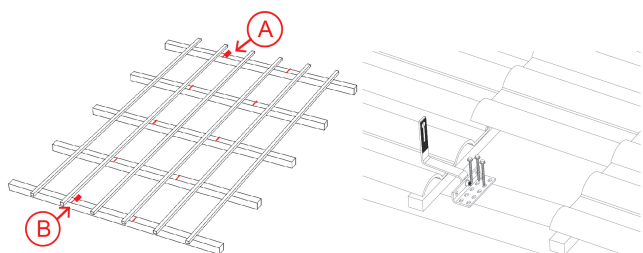

### Step 2 Installation-Click Holder

Push the screw head out and insert to the hook key hole, then move to proper position

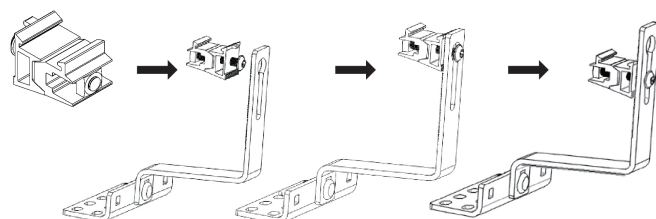

### Step 3 Installation- Splice

Connect 2 pcs of A43 rails with Splice

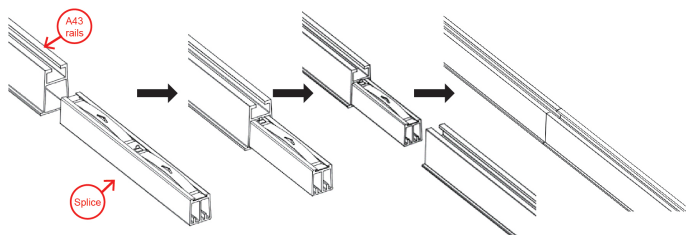

### Step 4 Installation-Rail

Click A43 Rail into the click holder, then lift the whole rail line to a proper height

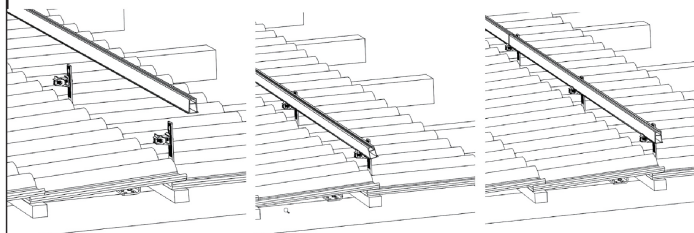

### Step 5 Installation-Clamp

15Nm  
Click End clamp into the rail  
to fix the panel by fastening  
the screw.

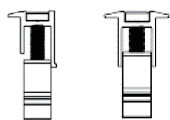

A: End clamp B: Mid clamp

Click mid clamp to the rail, push  
2nd rail above rail, fasten both  
panels with mid clamp screws.

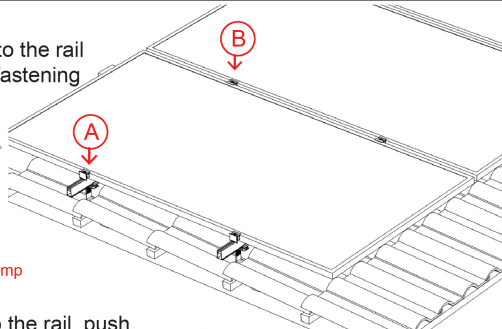

### Step 6 Installation-Completed

